



TC-V5211X

Quick Guide

FCC Compliance Statement

THIS EQUIPMENT HAS BEEN TESTED AND FOUND TO COMPLY WITH THE LIMITS FOR A CLASS A DIGITAL DEVICE, PURSUANT TO PART 15 OF THE FCC RULES. THESE LIMITS ARE DESIGNED TO PROVIDE REASONABLE PROTECTION AGAINST HARMFUL INTERFERENCE WHEN THE EQUIPMENT IS OPERATED IN A COMMERCIAL ENVIRONMENT. THIS EQUIPMENT GENERATES, USES, AND CAN RADIATE RADIO FREQUENCY ENERGY AND IF NOT INSTALLED AND USED IN ACCORDANCE WITH THE INSTRUCTION MANUAL, MAY CAUSE HARMFUL INTERFERENCE TO RADIO COMMUNICATIONS. OPERATION OF THIS EQUIPMENT IN A RESIDENTIAL AREA IS LIKELY TO CAUSE HARMFUL INTERFERENCE, IN WHICH CASE USERS WILL BE REQUIRED TO CORRECT THE INTERFERENCE AT THEIR OWN EXPENSE.

WARNING: CHANGES OR MODIFICATIONS NOT EXPRESSLY APPROVED BY THE PARTY RESPONSIBLE FOR COMPLIANCE COULD VOID THE USER'S AUTHORITY TO OPERATE THE EQUIPMENT. THIS CLASS OF DIGITAL APPARATUS MEETS ALL REQUIREMENTS OF THE CANADIAN INTERFERENCE CAUSING EQUIPMENT REGULATIONS.

WEEE (Waste Electrical & Electronic Equipment)

Correct Disposal of This Product (Applicable in the European Union and other European countries with separate collection systems)



This marking shown on the product or its literature, indicates that it should not be disposed with other household wastes at the end of its working life. To prevent possible harm to the environment or human health from uncontrolled waste disposal, please separate this from other types of wastes and recycle it responsibly to promote the sustainable reuse of material resources.

Household users should contact either the retailer where they purchased this product, or their local government office, for details of where and how they can take this item for environmentally safe recycling.

Business users should contact their supplier and check the terms and conditions of the purchase contract. This product should not be mixed with other commercial wastes for disposal.

Body

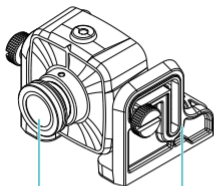

1 Lens

2 Mount Bracket

Accessories

1. Network Camera
2. Quick Guide
3. Screws (2ea)
4. In/Out Port

In/Out Port

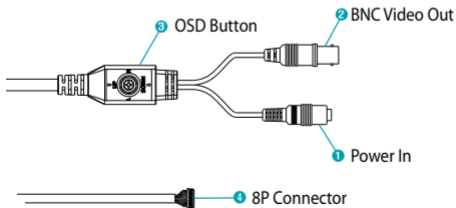

3 OSD Button

2 BNC Video Out

1 Power In

4 8P Connector

Installation

When installed to a front panel

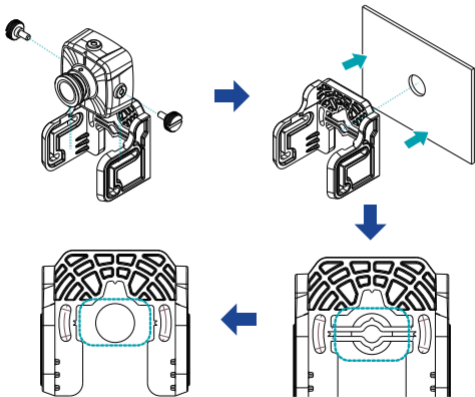

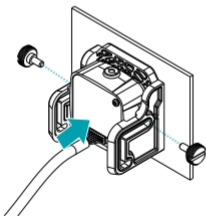
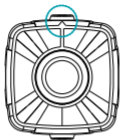



- Check the wall or ceiling to see if it needs to be reinforced. The camera may fall off if the wall or ceiling is not strong enough to support its weight.
- Install the camera in a shaded area. If the camera is installed in direct sunlight, it may be affected adversely.

1. Disassemble the screws on the left and right side to take the camera apart.

2. Remove a sheet on the double-sided tape on the bracket, and attach the bracket to a wall by matching the hole .

*When attaching the bracket, remove dust or oil and moisture from the installation surface and apply sufficient pressure to ensure that the applied face completely makes contact with the installation surface.

3~4. Remove the guide shap from the bracket using a nipper.

5. Check the location of the arrow as shown below, and assemble the camera to the bracket so that the arrow is located upwards. After fixing the left and right sides using screws, connect the cable.

*The area with the arrow corresponds to the top part of the video.

*The cable may be disconnected due to its weight. Please make sure to fix the cable tightly on to a certain area in order not to be disconnected.

When installed to other spaces

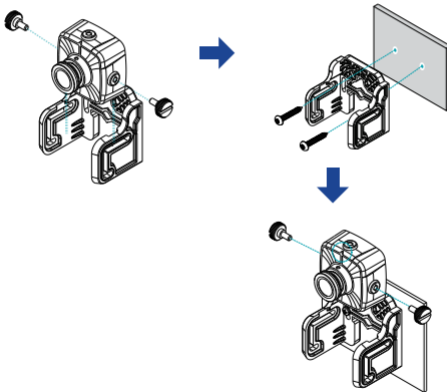

1. Disassemble the screws on the left and right side to take the camera apart.

2. Fix the bracket to a wall or ceiling using doublesided tape or screws.

*When attaching the bracket by double-sided tape, remove dust or oil and moisture from the installation surface and apply sufficient pressure to ensure that the applied face completely makes contact with the installation surface.

3. Fasten the camera body on the bracket after rotating it to the appropriate video direction. After fixing the left and right sides using screws, connect the cable.

*The area with the arrow corresponds to the top part of the video.

*The cable may be disconnected due to its weight. Please make sure to fix the cable tightly on to a certain area in order not to be disconnected.

4. Connect the cable and the power adapter.

5. Connect the power.

Dimension

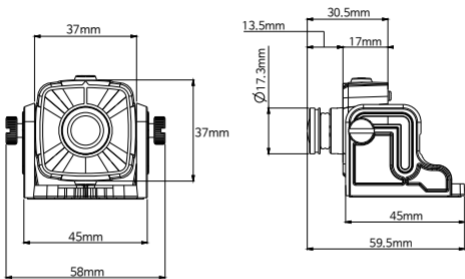

Specifications

Supported Resolution	1920x1080, 720 X 480
Image Sensor	1/2.8" CMOS
Lens	2.4mm Fixed-focal lens
Video Compression	TVI / AHD / SD
Power Source	DC 12V
Power Consumption	Max 1.6W

※ Please download software (IDIS Discovery, IDIS Center, IDIS Solution Suite Compact) and product manual from this link :

- IDIS Website (www.idisglobal.com)